

Base Curb Detail

NO SCALE

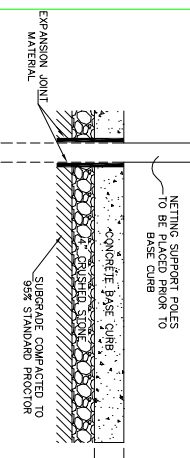

Base Anchor Detail

NO SCALE

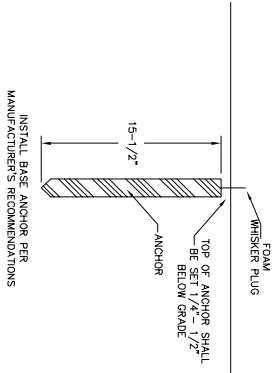

Batter's Box Detail

NO SCALE

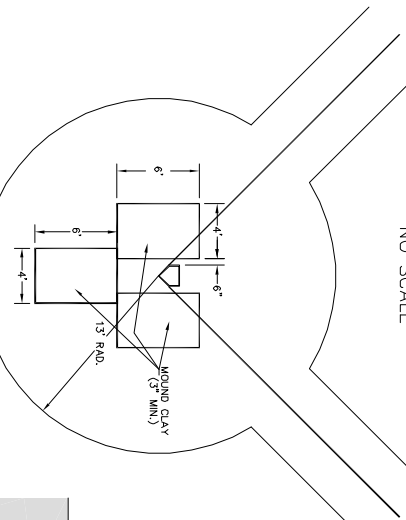

Bleachers - 42 Seats Each
Contractor to bid 2 Seats per field
- Beacon Athletics Standard Aluminum Bleachers
(Product Code 115-765-239)
or equivalent

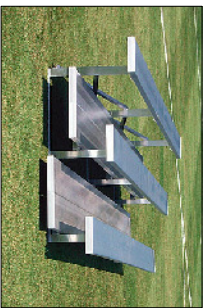

Concrete curb between dugouts

NOTE:
Refer to Architectural Plans for Dugout Specs. Dugout is not part of Base Bid.

Grass Area Cross-Section

NO SCALE

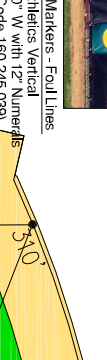

Electronic Scoreboard
(Per Spec - Not in This Contract)

Beacon Athletics Standard
38" H x 56" W with 24" Numerals
(Product Code 160-245-XXX)
or equivalent

Skinned Area Cross-Section

NO SCALE

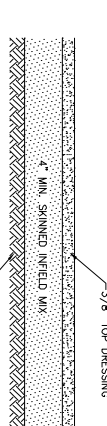

Drain Tile Detail

(FOR NATURAL TURF OPTION ONLY)
NO SCALE

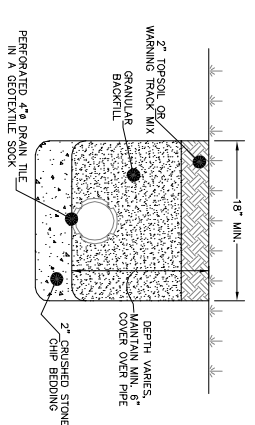

NOTE:
PROVIDED MANUFACTURED TEE CONNECTION TO STORM SEWER

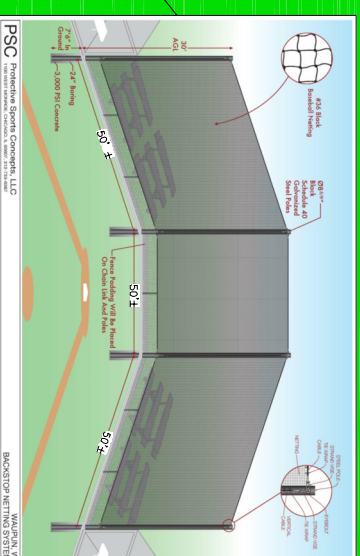
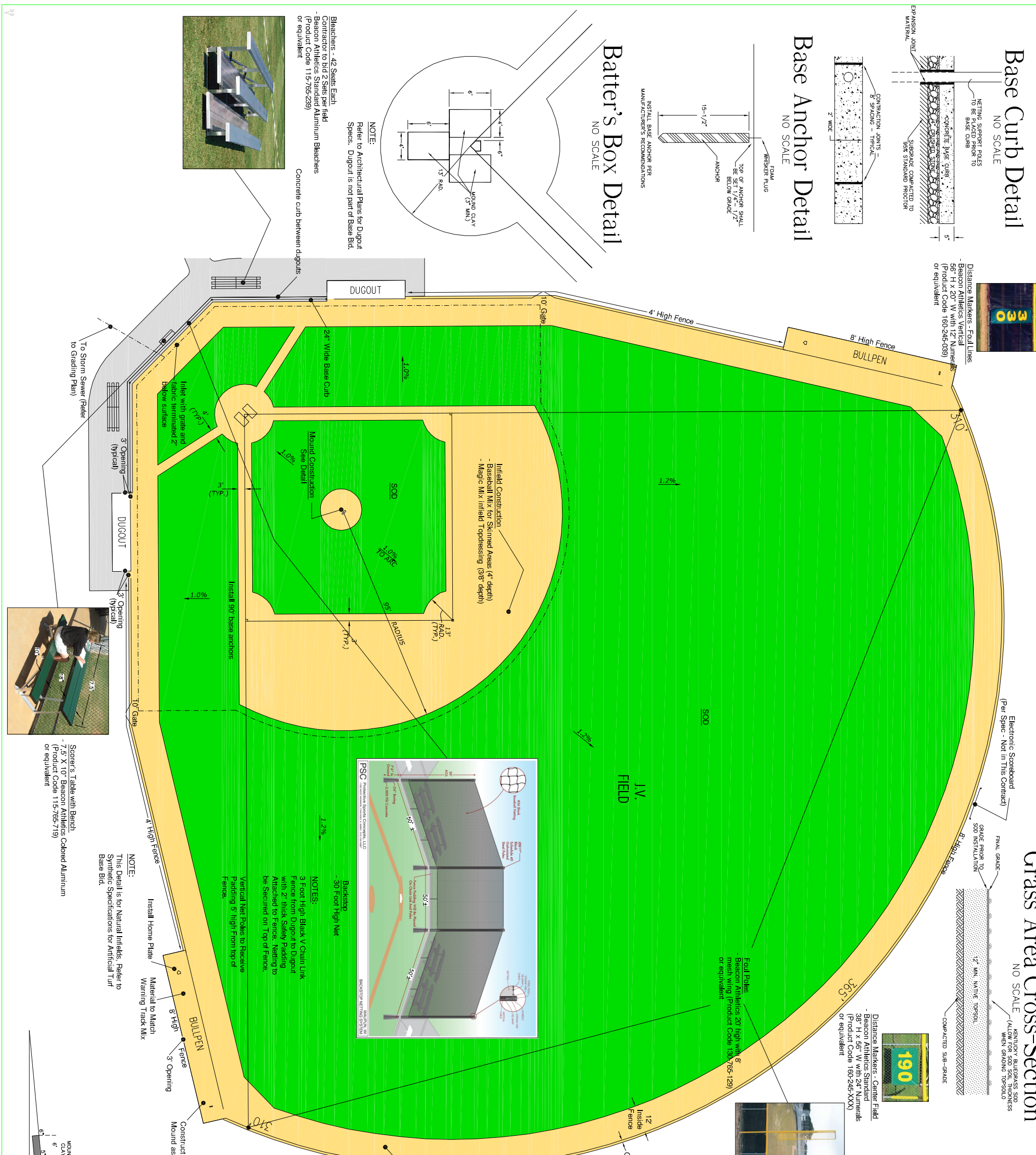

Mound Detail

NO SCALE

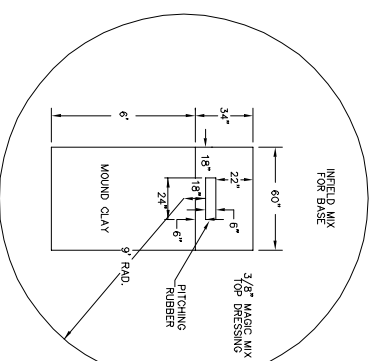

Mound Profile

NO SCALE

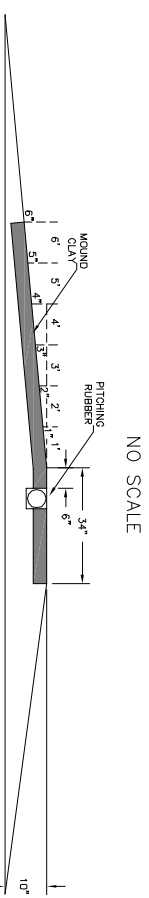

Waupun Sports Complex



55 S. 3RD AVENUE
P.O. BOX 105
STURGEON BAY, W.
54235
PHONE: 920-743-8211
FAX: 920-743-8217

PROJECT DIRECTORY: MAUSTON OPTIONS	DRAWN BY: P.J.H.
DATE: 5-13-11	DESIGNED BY: P.J.H.
REVISIONS:	JOB NUMBER: 21445
SCALE: 1" = 20'	

REUSE OF DOCUMENTS
THIS DOCUMENT HAS BEEN DEVELOPED FOR A SPECIFIC APPLICATION AND NOT FOR GENERAL USE. THEREFORE, IT MAY NOT BE USED WITHOUT THE WRITTEN APPROVAL OF BAUDHUIN INCORPORATED. UNAPPROVED USE IS THE SOLE RESPONSIBILITY OF THE UNAUTHORIZED USER.

JV
FIELD DETAIL